

Standard Ballasts 18–58 W, 230 V

For compact fluorescent lamps
Shape: 28 x 41 mm

Vacuum-impregnated with polyester resin

Push-in terminal for leads: 0.5–1 mm²

For the automatic luminaire wiring:

IDC terminals for leads H05V-U 0.5

tw 130

Protection class I

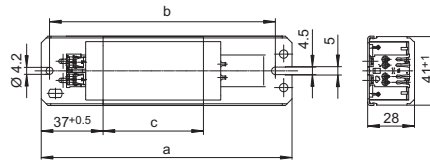
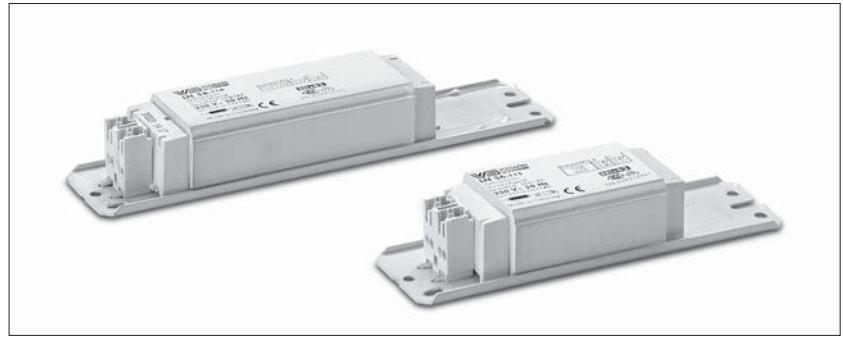

Lamp				Ballast										Capacitor	
Output	Type	Base	Current	Type	Ref. No.	Voltage	a	b	c	Weight	$\Delta t/\Delta t_{an}$	Energy efficiency*	C _p	Current	
W			mA			V, Hz	mm	mm	mm	kg	K	%	μF	mA	
230 V, 50 Hz															
18	TC-D/TC-T	G24d-2/GX24d-2	220	LN 181.940	508922	230, 50	85	75	34	0.32	50/120	B1	2.0	110	
				LN 181.319	163763	230, 50	85	75	34	0.32	60/140	B1	2.0	110	
	TC-F/TC-L	2G10/2G11	370	LN 18.510	164572	230, 50	155	140	92	0.80	40/65	B1	4.5	120	
				LN 18.131	530941	230, 50	150	140	60	0.55	55/95	B2	4.5	120	
				L 18.934**	534621	230, 50	150	140	45	0.43	70/150	–	4.5	120	
	T-U	2G13	370	LN 18.131	530941	230, 50	150	140	60	0.55	55/95	B2	4.5	120	
L 18.934**				534621	230, 50	150	140	45	0.43	70/150	–	4.5	120		
2x18	TC-F/TC-L	2G10/2G11	400	LN 2x18.135	532155	230, 50	150	140	45	0.43	65	B1	4.0	210	
				L 36.334	530007	230, 50	150	140	60	0.55	60/155	B1	4.0	210	
new 22	T-R	G10q	400	LN 30.530	164680	230, 50	155	140	92	0.80	45/65	B2	4.5	200	
24	TC-F/TC-L	2G10/2G11	345	LN 24/26.804	534490	230, 50	150	140	60	0.55	55/110	B2	4.5	150	
				L 18.934**	534621	230, 50	150	140	45	0.43	70/150	–	4.5	150	
26	TC-D/TC-T	G24d-3/GX24d-3	325	LN 18.131	530941	230, 50	150	140	60	0.55	55/95	B1	3.5	140	
				LN 26.813	509502	230, 50	110	100	45	0.41	55/145	B2	3.5	140	
				L 18.934**	534621	230, 50	150	140	45	0.43	70/150	–	3.5	140	
28	TC-DD	GR8/GR10q	320	LN 18.510	164572	230, 50	155	140	92	0.80	40/65	B1	3.5	150	
				LN 18.131	530941	230, 50	150	140	60	0.55	55/95	B1	3.5	150	
				L 18.934**	534621	230, 50	150	140	45	0.43	70/150	–	3.5	150	
new 36	TC-F/TC-L	2G10/2G11	430	LN 36.570	169779	230, 50	155	140	92	0.80	35/90	B1	4.5	210	
				LN 36.511	164590	230, 50	155	140	92	0.80	35/95	B1	4.5	210	
				LN 36.130	527191	230, 50	150	140	60	0.55	50/140	B2	4.5	210	
				LN 36.149	529029	230, 50	150	140	60	0.55	55/150	B2	4.5	210	
				L 36.132**	535977	230, 50	150	140	45	0.43	65	–	4.5	210	
new 36/40	T-U/T-R	2G13/G10q	430	LN 36.570	169779	230, 50	150	140	92	0.80	35/90	B1	4.5	210	
				LN 36.149	529029	230, 50	150	140	60	0.55	55/150	B2	4.5	210	
				L 36.132**	535977	230, 50	150	140	45	0.43	65	–	4.5	210	
new 38	TC-DD	GR10q	430	LN 36.570	169779	230, 50	155	140	92	0.80	35/90	B1	4.5	210	
				LN 36.149	529029	230, 50	150	140	60	0.55	55/150	B2	4.5	210	
				L 36.132**	535977	230, 50	150	140	45	0.43	65	–	4.5	210	
new 58	T-U	2G13	670	LN 58.568	169389	230, 50	233	220	160	1.31	35/95	B1	7.0	320	
				LN 58.189	537038	230, 50	190	180	100	0.87	50/135	B2	7.0	320	
				LN 58.116	508186	230, 50	190	180	92	0.80	55/160	B2	7.0	320	
				L 58.718**	169658	230, 50	190	180	92	0.80	60/170	–	7.0	320	

* Energy efficiency: EEI=B2 and EEI=B1, valid until 2017

** Ballasts without CE mark for markets outside of the EU